



Horse Creek

---

*Useppa*



# Useppa

3 Bedroom | 2.5 Bath | Great Room | 2-Car Garage

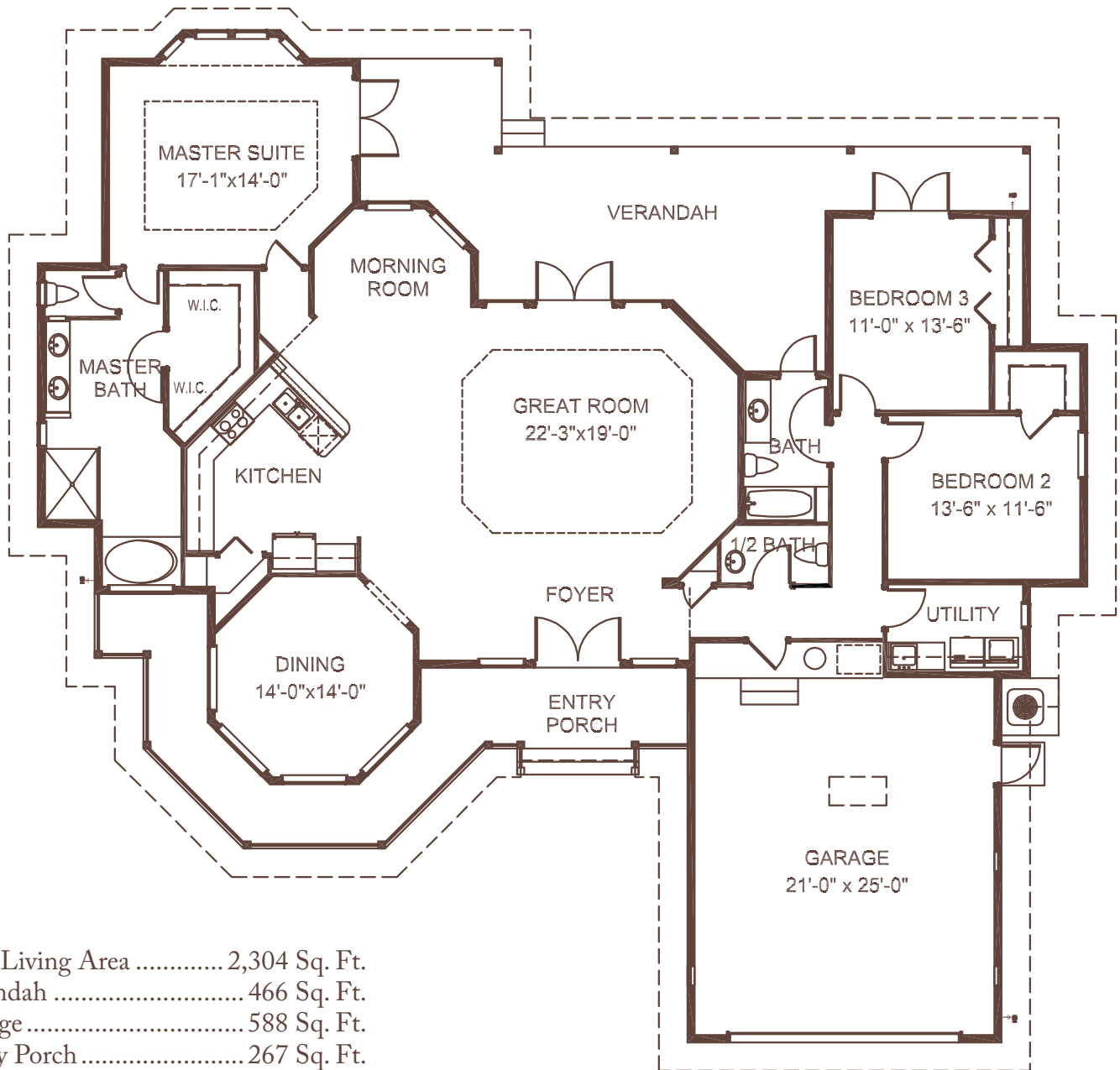

A/C Living Area .....	2,304 Sq. Ft.
Verandah .....	466 Sq. Ft.
Garage .....	588 Sq. Ft.
Entry Porch .....	267 Sq. Ft.
<b>TOTAL .....</b>	<b>3,625 Sq. Ft.</b>

Offered exclusively by



HorseCreekCommunity.com | 239.332.7335 | Fort Myers, Florida 33905



Because of ongoing research to develop better building methods and materials, we reserve the right to change elevations, specifications, dimensions, design, materials and price without prior notice. CGC034850 ©2017 Daniel Wayne Homes, Inc.